

- D Montageanleitung
E Mounting instructions
HR Naputci za montažu
SLO Navodila za montažo
HU Szerelési útmutató
RO Instrucțiuni de montaj
CZ Montážní návod
SK Montážní návod
BG Инструкции за инсталиране
PL Instrukcja instalacji
GR Οδηγίες Εγκατάστασης
IT Istruzioni per l'installazione

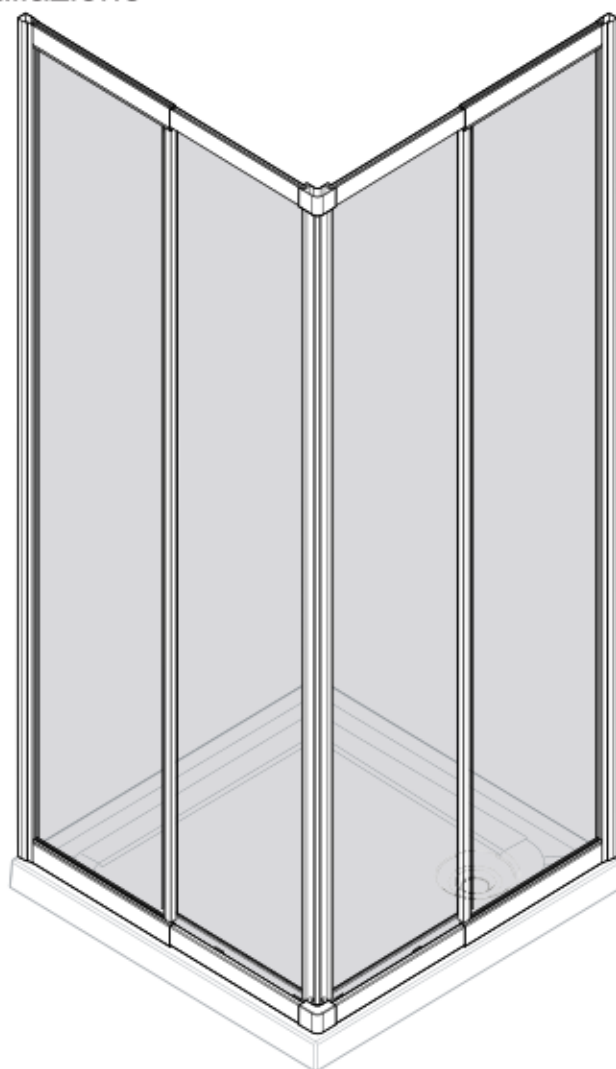

DUSCHMEISTER

Der Spezialist für Dusche und Bad

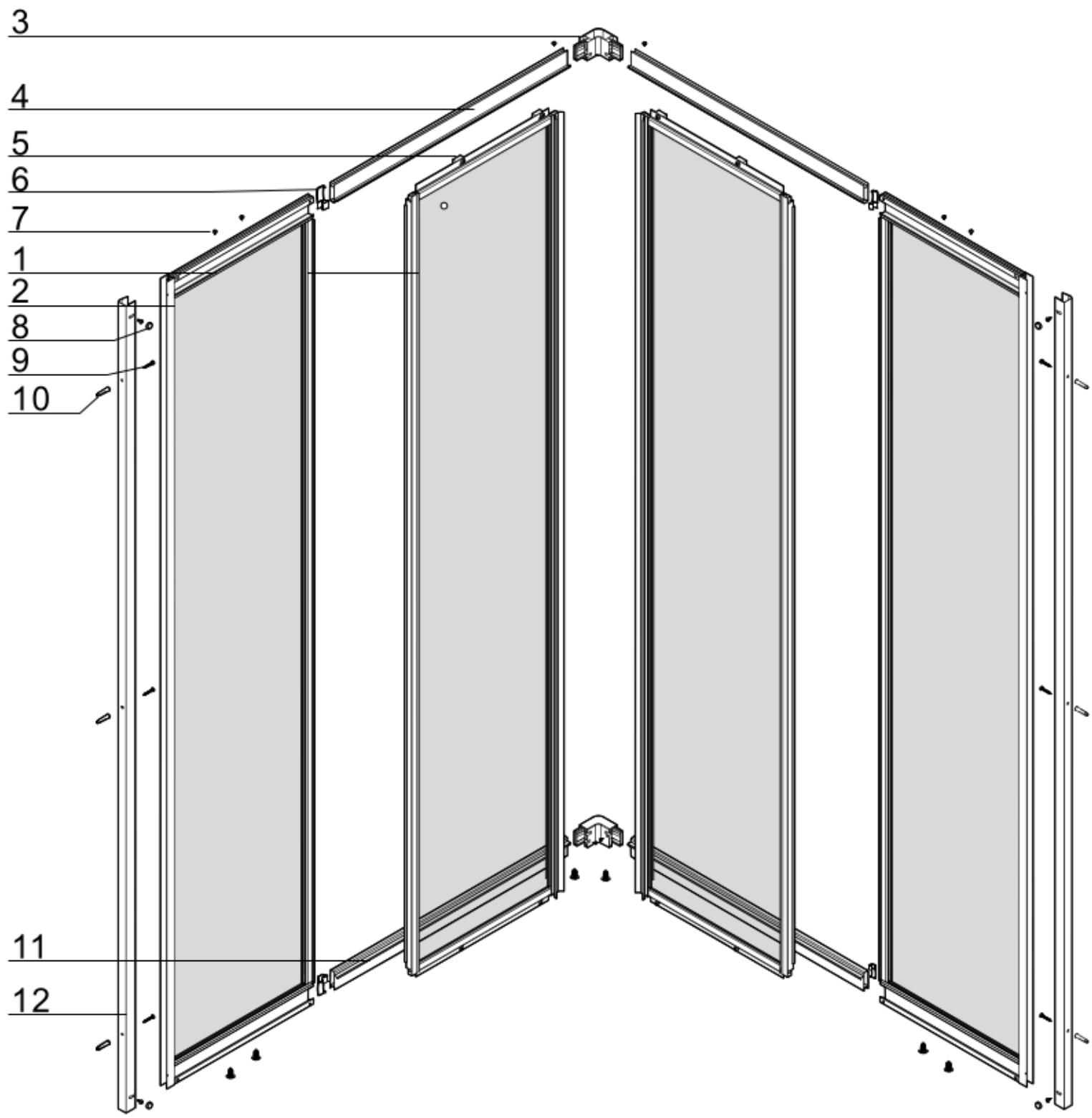

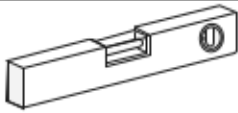

1



X2

2



X2

3



X2

4

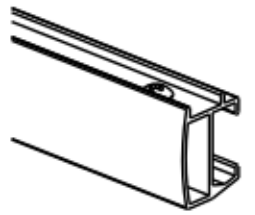

X2

5

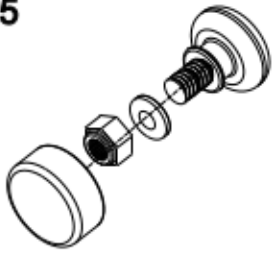

X8

6

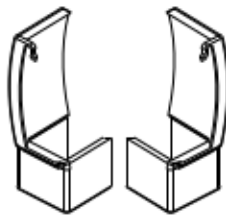

X4

7



3.5X9.5 X18

8

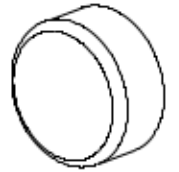

X6

9



3.5X32 X6

10



X6

11

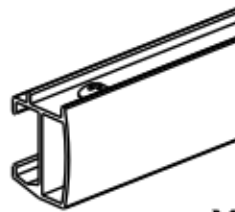

X2

12

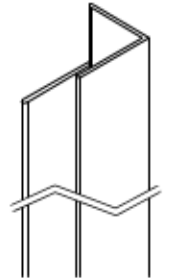

X2

