

708-0  
01-23

**- Montageanleitung -**  
(bitte zusammen mit dem Kaufbeleg aufbewahren)

---

D96354

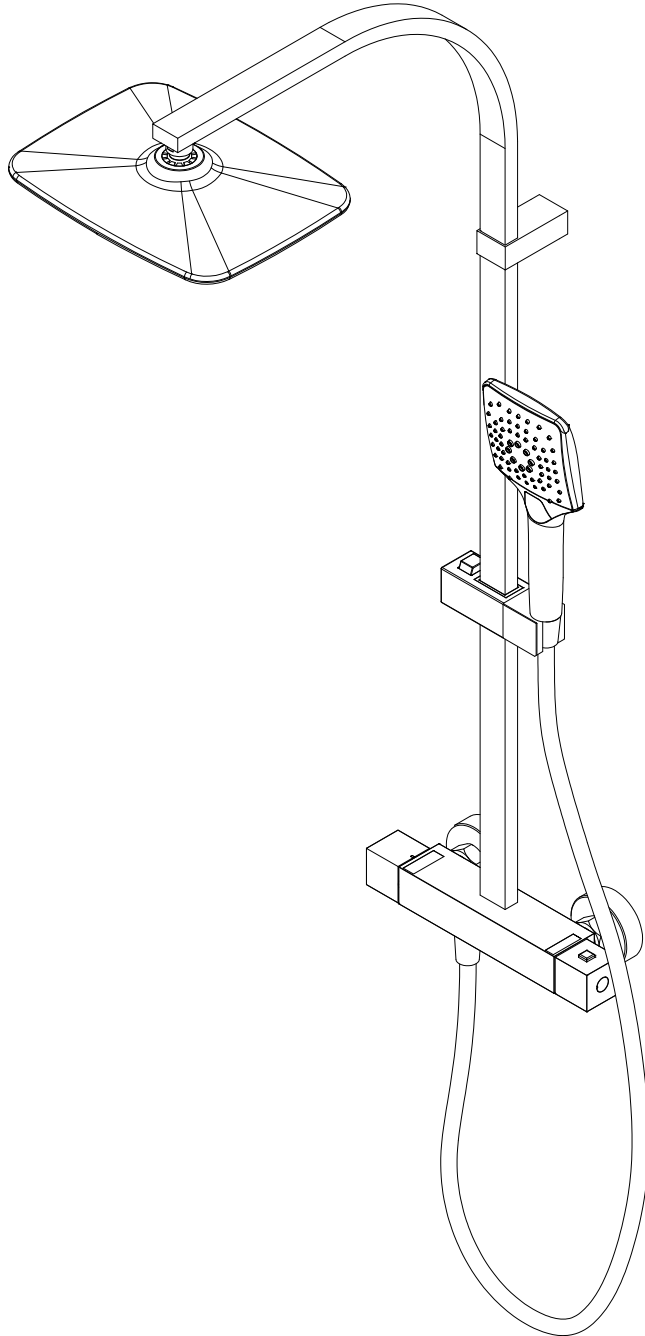

---

**- Assembly instructions -**  
(please retain and file together with the purchase receipt)

**- Notice de montage -**  
(à conserver et à accrocher impérativement avec le justificatif d'achat)

**- Montagehandleiding -**  
(samen met de aankoopfactuur in ieder geval bewaren)

# Maßzeichnung, dimensional drawing, dimensions, maatekening

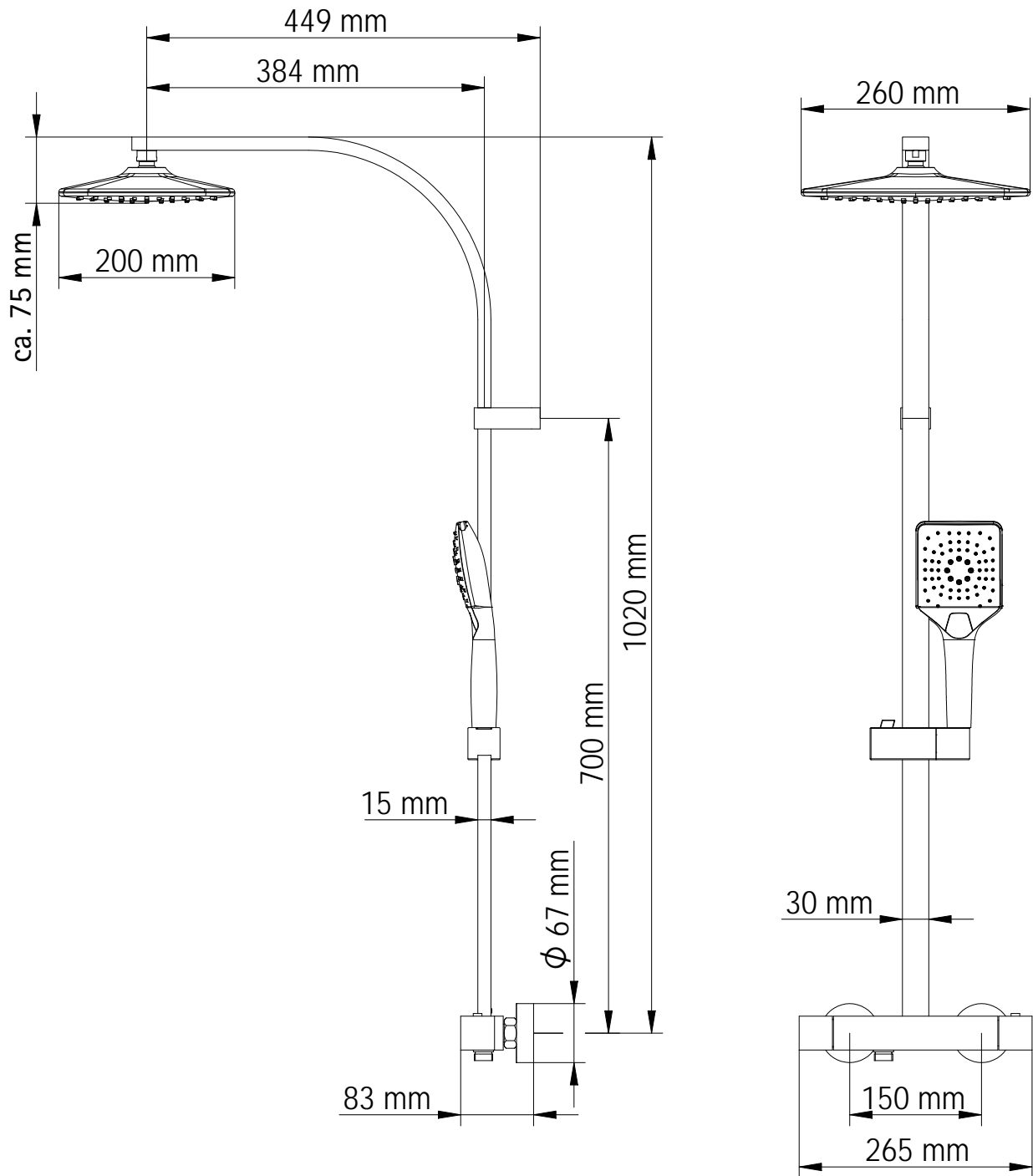

## Info

- de** Alle Maßangaben unterliegen einer Toleranz von  $\pm 5$  mm  
Maße teilweise abhängig von der Position der S-Anschlüsse und können fertigungsbedingt geringfügig variieren.
- en** All dimensions are subject to a tolerance of  $\pm 5$  mm  
Dimensions partly depend on the position of the S-connectors and because of manufacturing reasons, may vary slightly.
- fr** Toutes les mesures sont soumises à une tolérance de  $\pm 5$  mm  
La dimension dépend de la position des raccords excentriques en S et peut légèrement varier lors de la fabrication.
- nl** Alle maten hebben een tolerantie van  $\pm 5$  mm. Maten gedeeltelijk afhankelijk van de positie van de S-koppelingen en kunnen in verband met de fabricage minimaal variëren.

# Ersatzteilübersicht, spare parts overview, aperçu des pièces détachées, onderdelen overzicht

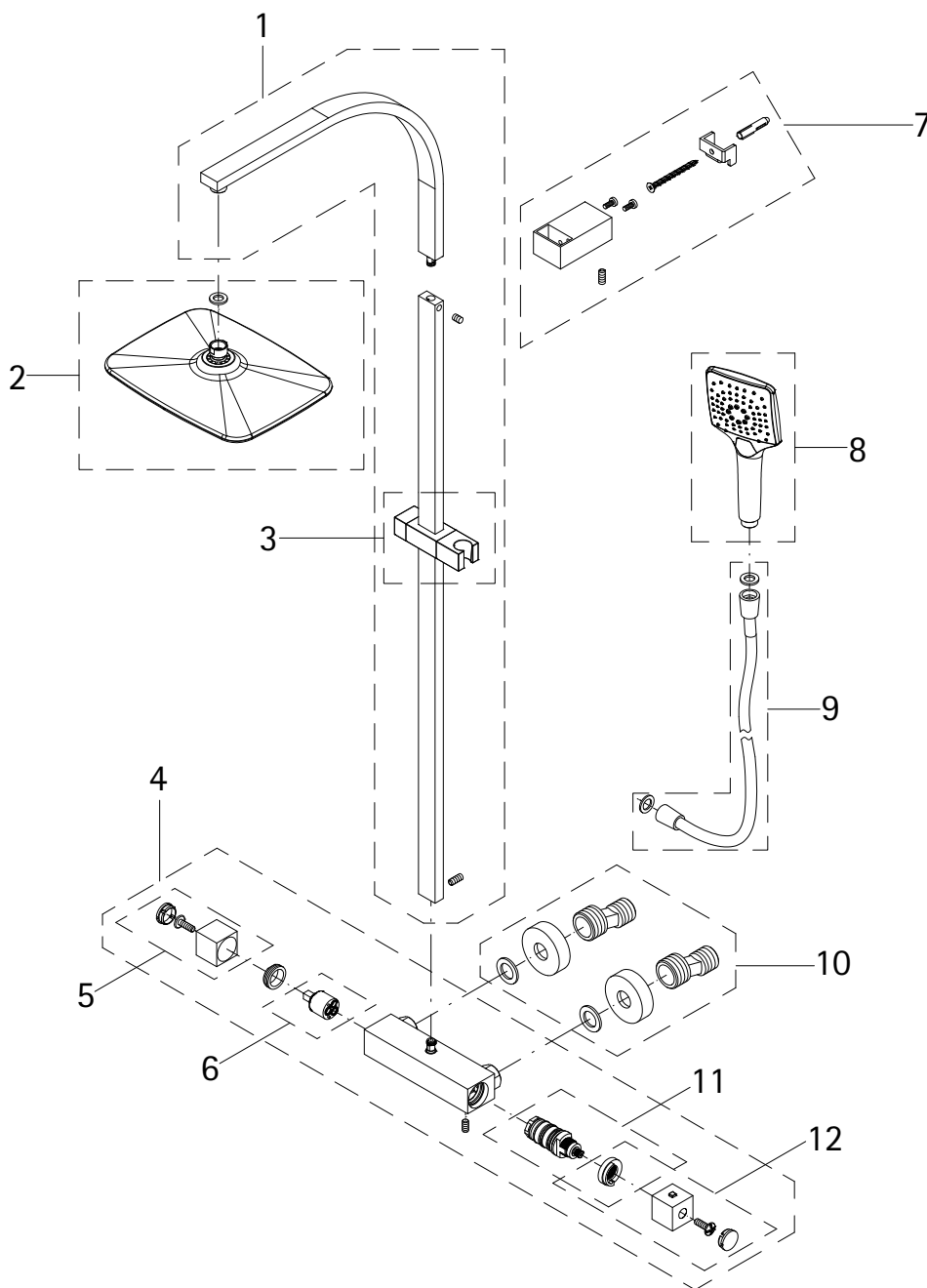

<b>Info</b>	<b>de</b>	Bei der Ersatzteilbestellung bitte unbedingt die entsprechende Artikelnummer vom Kaufbeleg angeben.	<b>fr</b>	Lors de la commande des pièces détachées veuillez donner le numéro d'article conforme au bon d'achat.
	<b>en</b>	When ordering spare parts, please specify the item on the order from.	<b>nl</b>	Bij een onderdeel bestelling het juiste artikelnummer overnemen vanaf het aankoopbewijs.

Pos.	Bezeichnung	Ersatzteil-Nr.	Preis	Pos.	Bezeichnung	Ersatzteil-Nr.	Preis
1	1x Rohrgestänge (Chromoptik)	E98595-2-41	Stück 106,95 €	8	1x Handbrause (White Style)	E98520-39-41	Stück 49,00 €
2	1x Kopfbrause, rechteck 260 x 200 mm (White Style)	E98521-40-41	Stück 98,00 €	9	1x Brauseschlauch 1,5 m (Chromoptik)	E98515-17-41	Stück 26,95 €
3	1x Gleiter mit Handbrausehalter (Chromoptik)	E98508-4-41	Stück 24,95 €	10	1x S-Anschlüsse mit Rosetten (Chromoptik)	E98559-4-41	Set 66,00 €
4	1x Thermostatarmatur komplett (Chromoptik)	E98569-22-41	Set 186,00 €	11	1x Thermostatkartusche	E98541-KT50	Stück 106,00 €
5	1x Griff Absperrventil, eckig (Chromoptik)	E98554-3-41	Stück 66,00 €	12	1x Thermostatgriff, eckig (Chromoptik)	E98560-5-41	Stück 66,00 €
6	1x Umstellerkartusche	E98575-KT24	Stück 52,00 €				
7	1x Wandanbindung (Chromoptik)	E98574-41	Stück 26,95 €		# Montagezubehör	E98500	Set 38,95 €

Benötigtes Werkzeug, Tools required, Outils nécessaires, Benodigd gereedschap

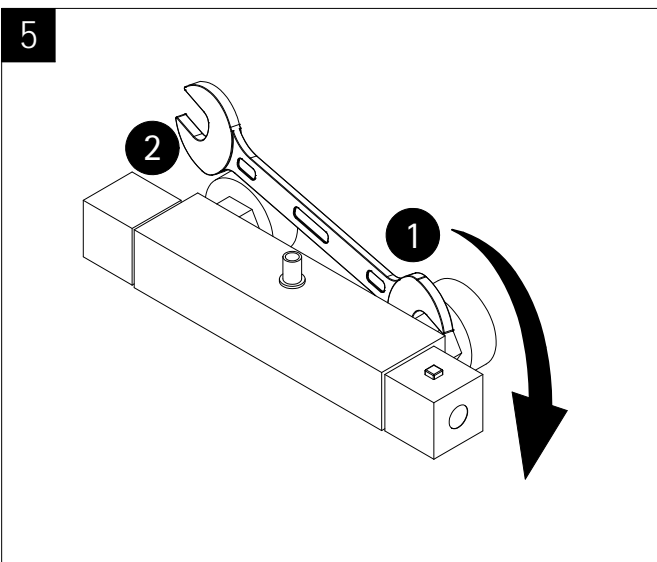
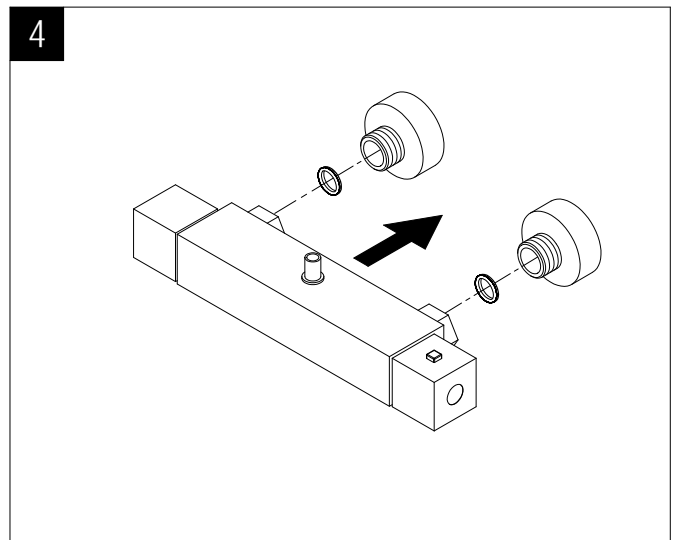
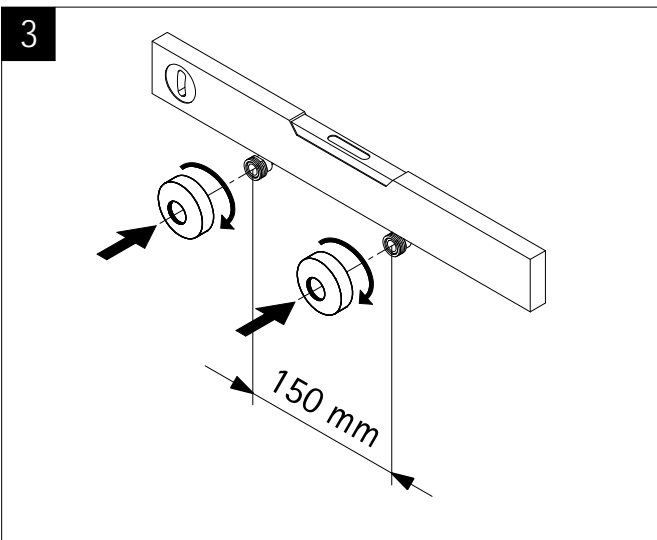
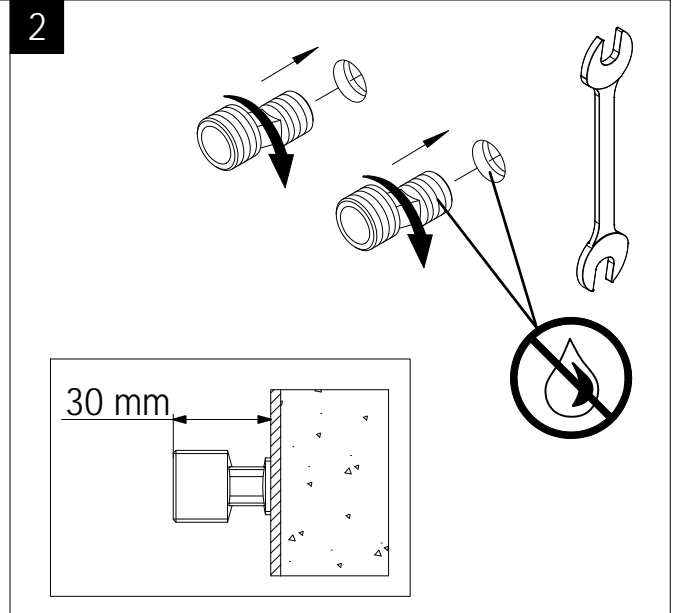
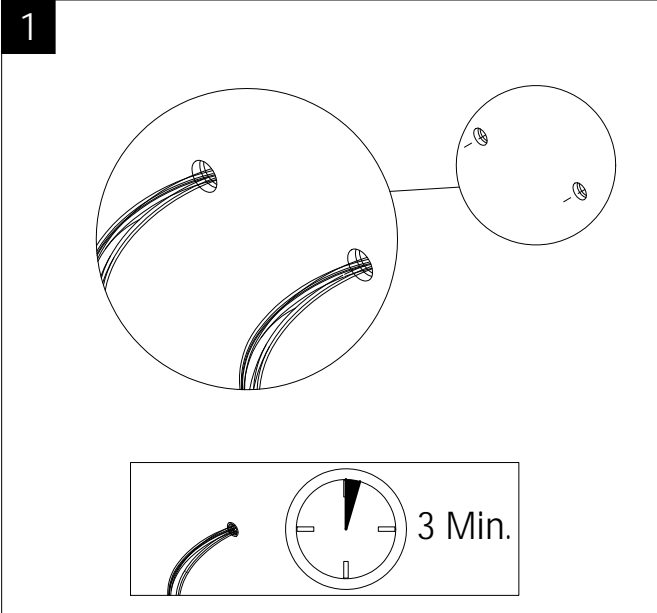
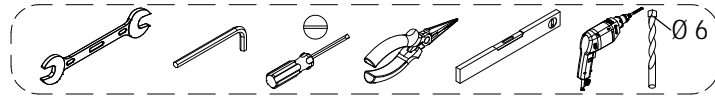

6

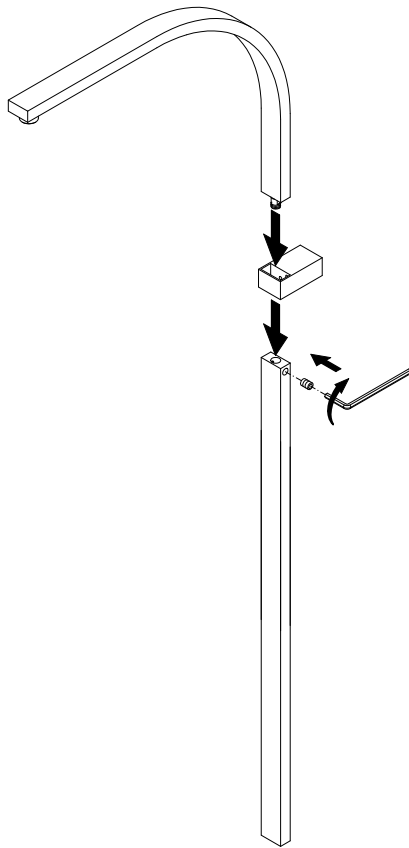

7

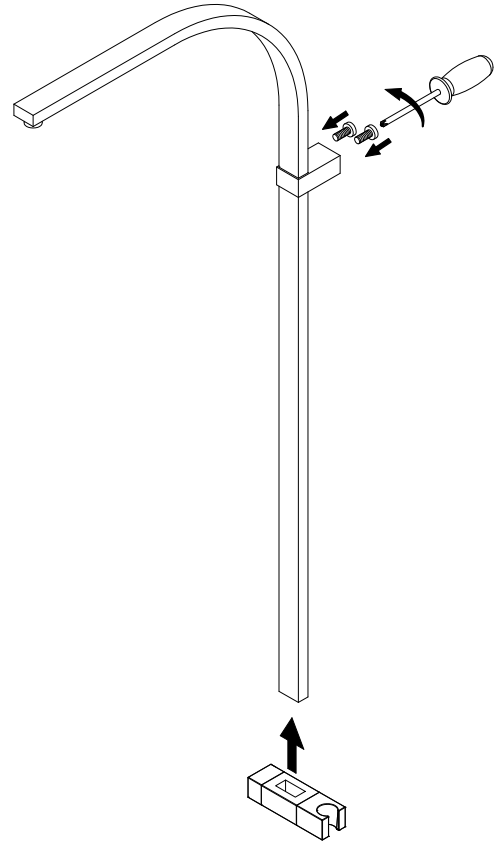

8

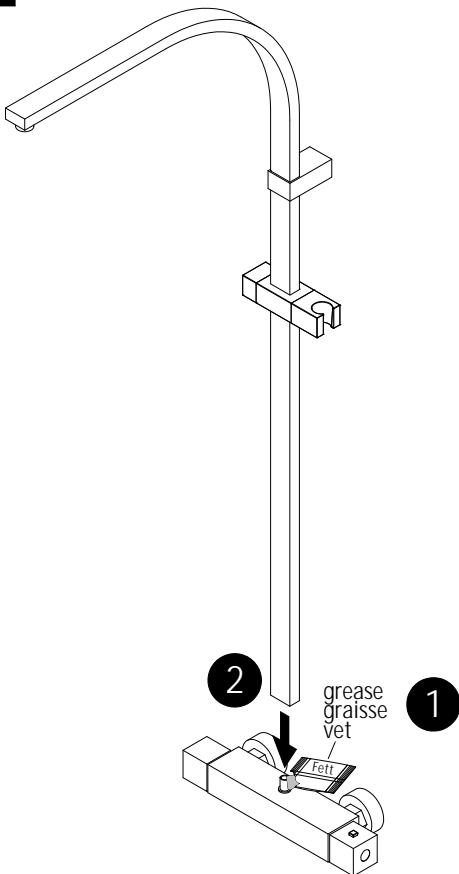

9

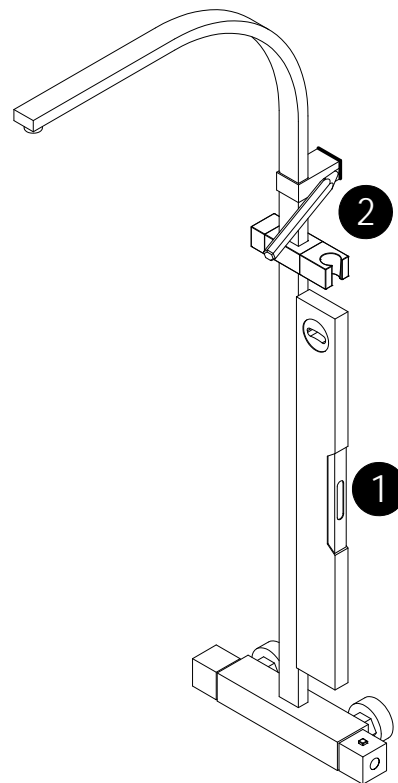

10

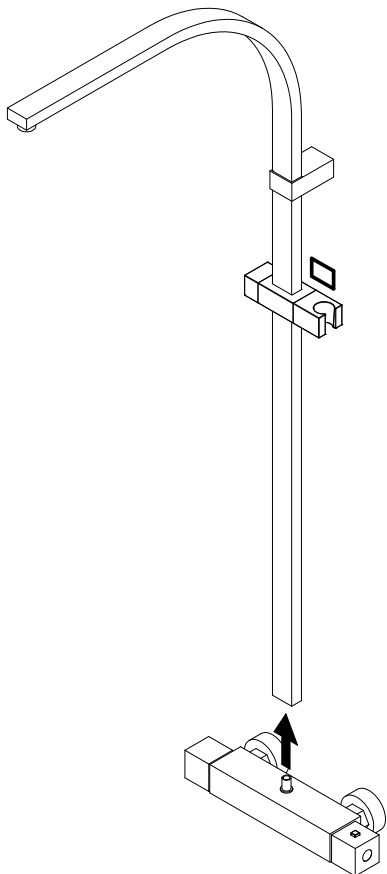

11

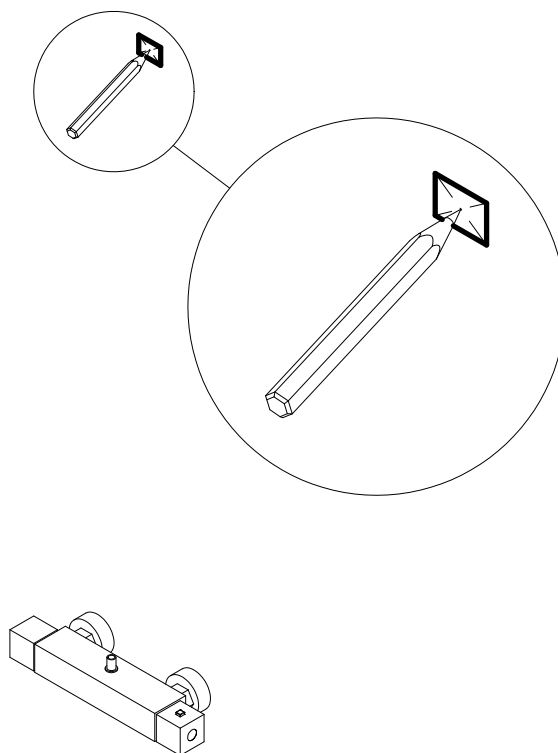

12

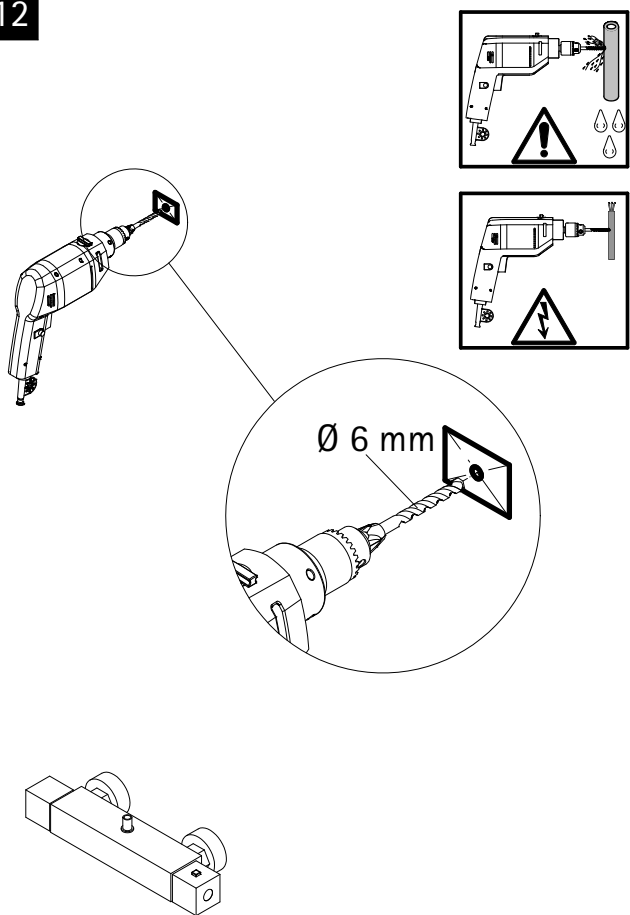

13

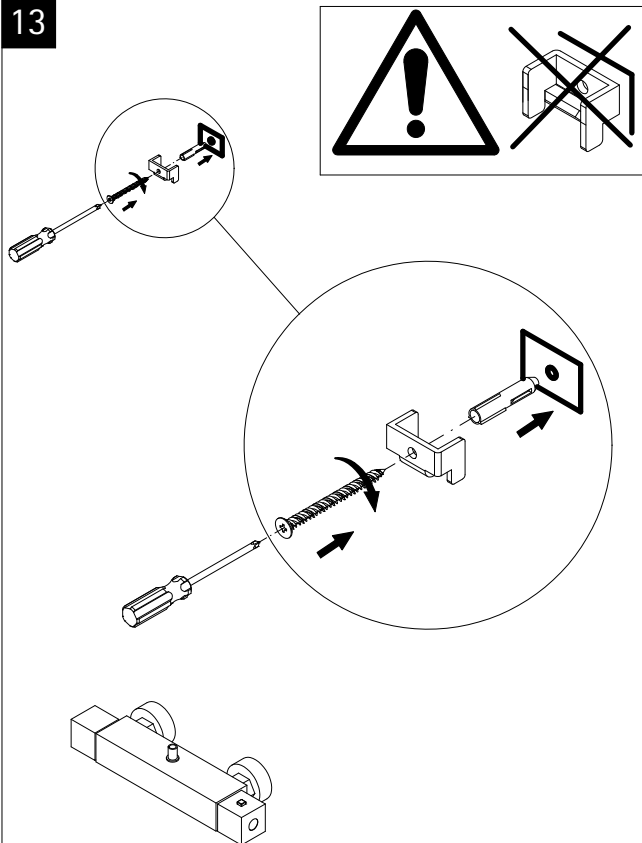

14

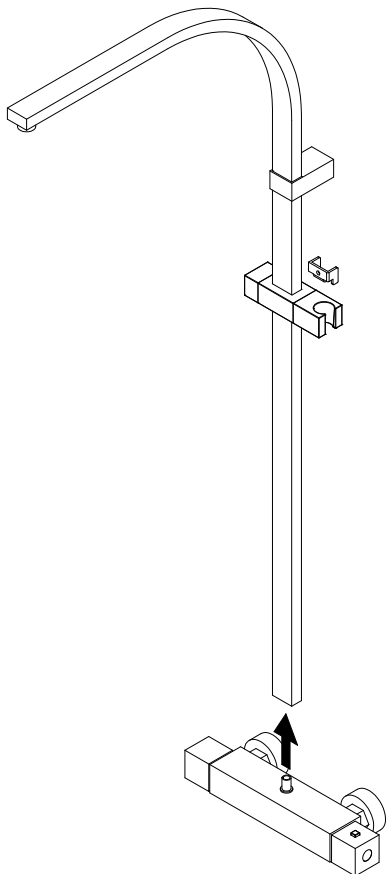

15

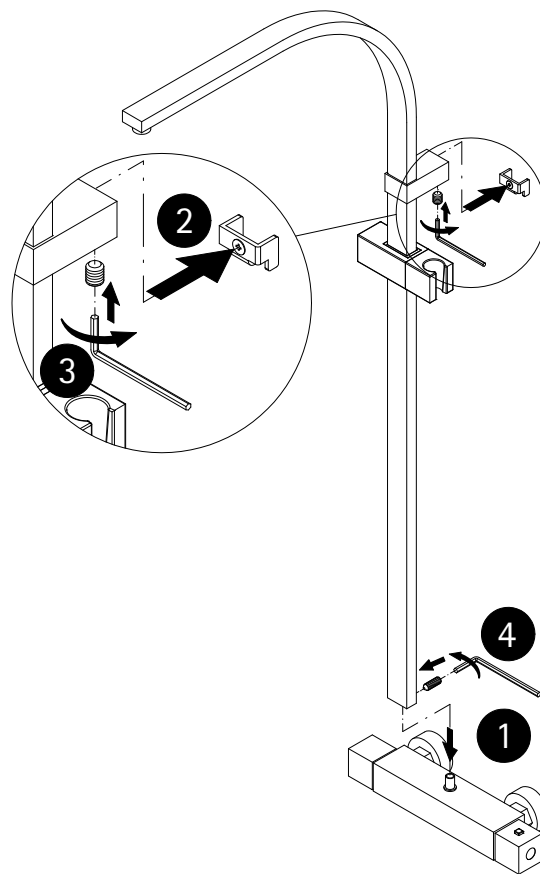

16

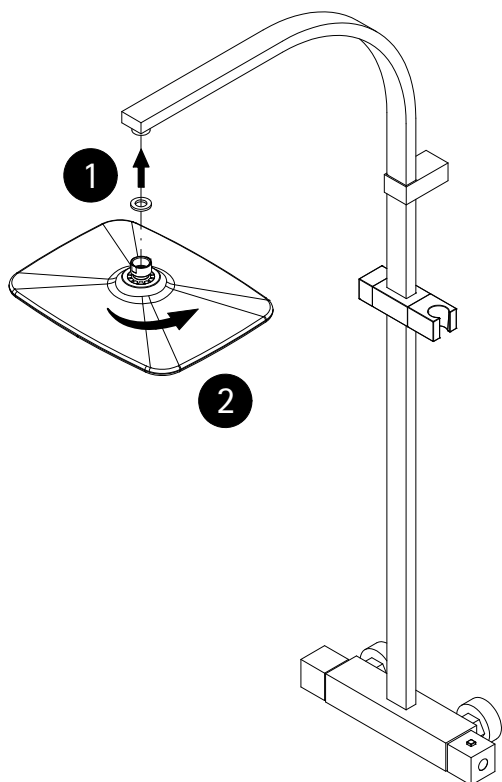

17

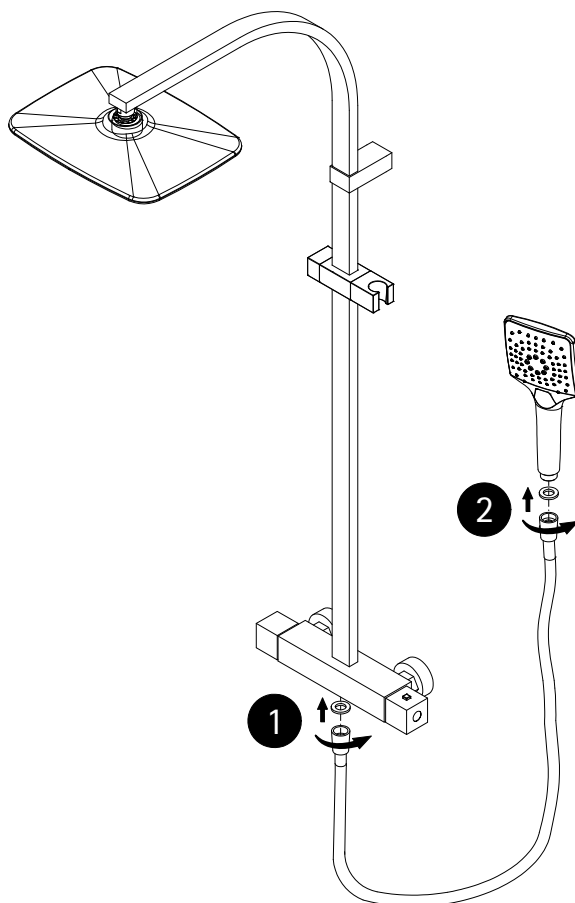

Info

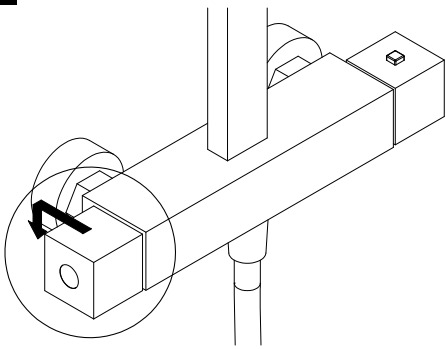

=

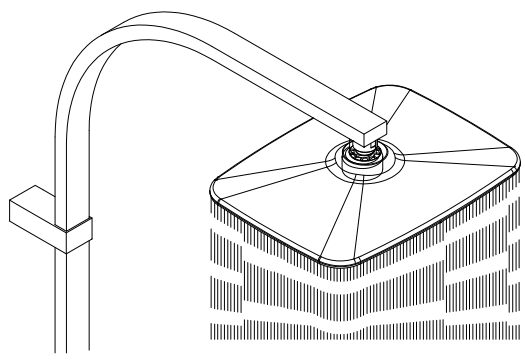

Info

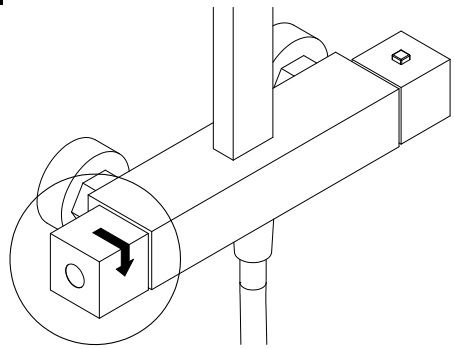

=

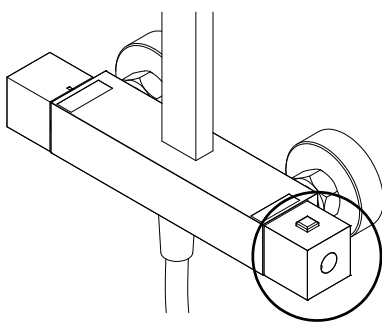
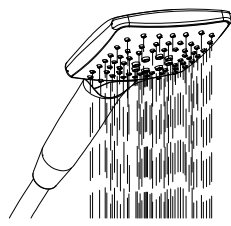

Info

- de kalt ❄️ / warm ☀️
- en cold ❄️ / hot ☀️
- fr froid ❄️ / chaud ☀️
- nl koud ❄️ / warm ☀️

Info

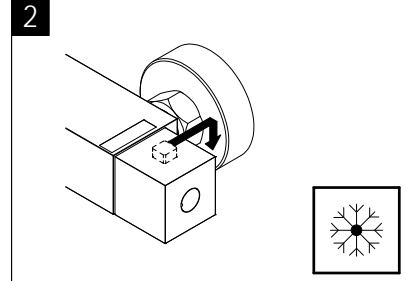
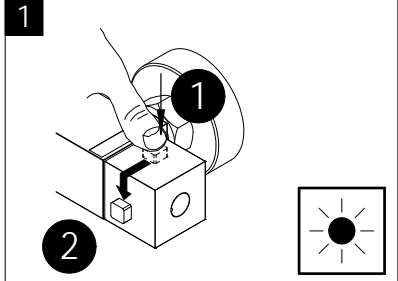
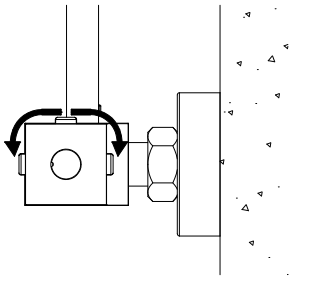



## Info

- de** Thermostatkartusche wechseln.  
Wasser abstellen!
- en** change the thermostat cartridge.  
turn off the water!
- fr** changez la cartouche du thermostat.  
couper l'arrivée d'eau!
- nl** eenhendelmenkraan wisselen.  
water afsluiten!

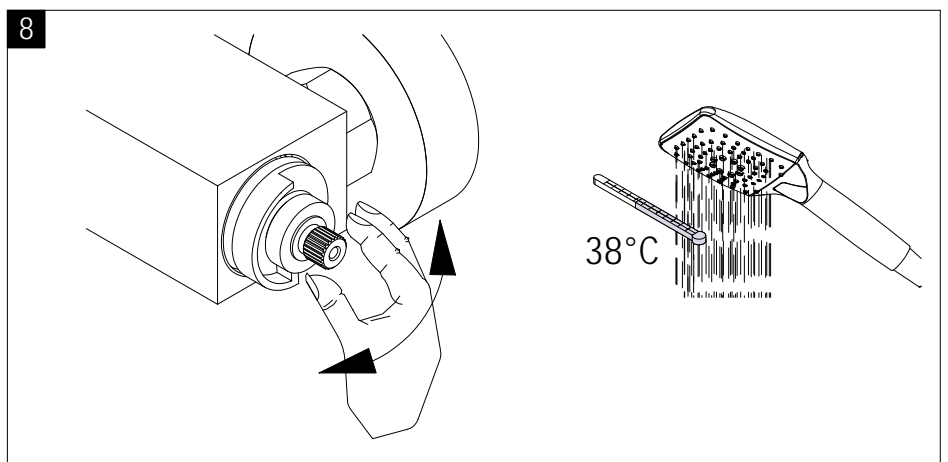
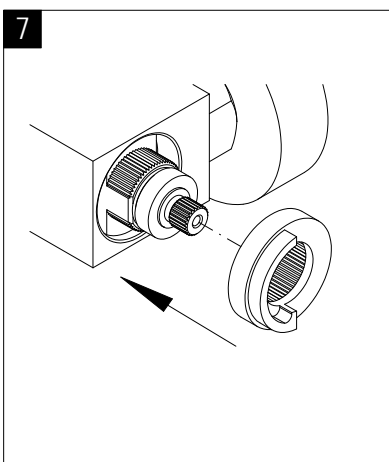
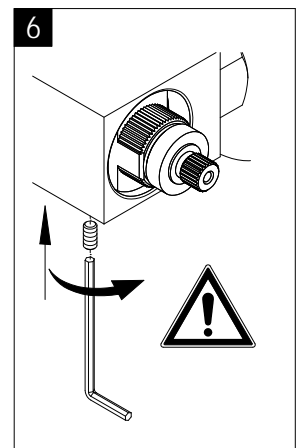
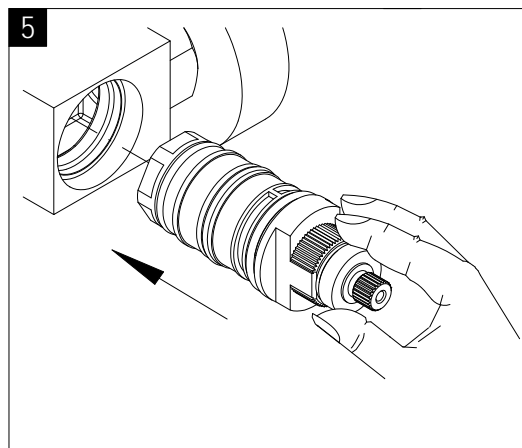
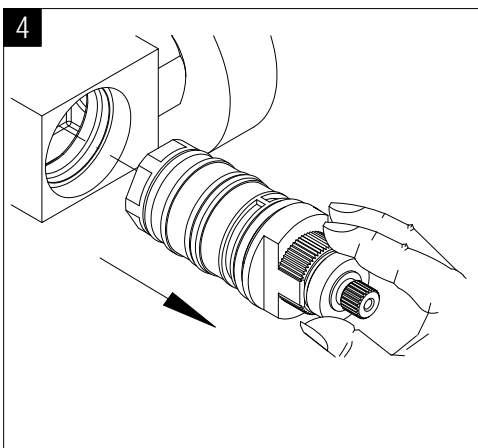
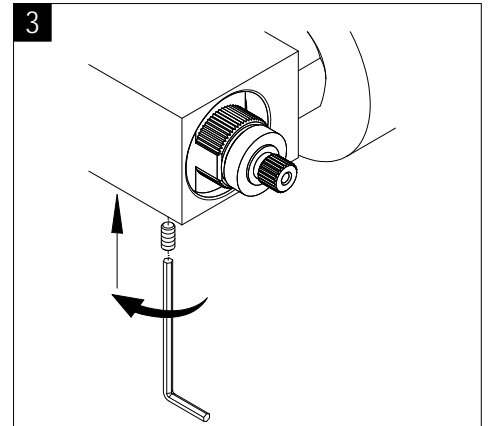
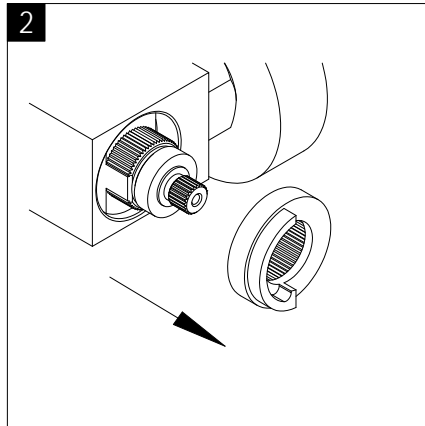
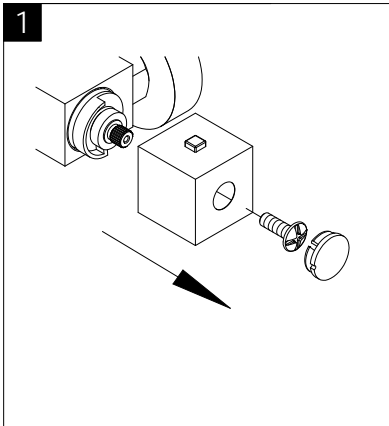
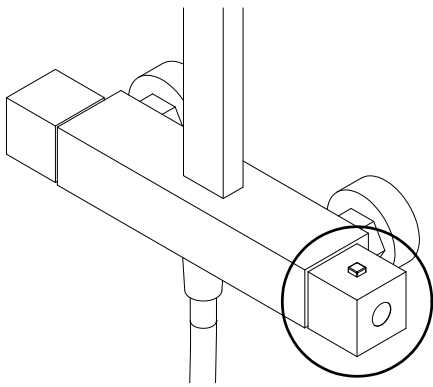

## Info

- de** Einbau in umgekehrter Reihenfolge.
- en** Installation in the reverse order.
- fr** Montage dans le sense inverse.
- nl** Inbouw in omgekeerde volgorde.

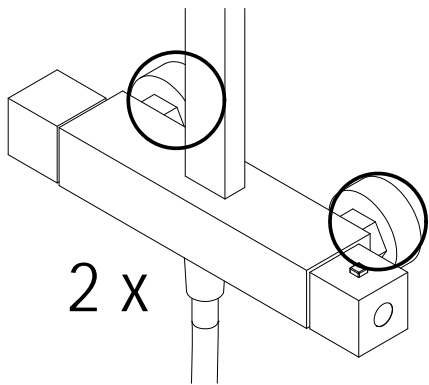

## Info

- de** Rückflussverhinderer wechseln.  
Wasser abstellen!
- en** non-return valve maintenance.  
turn of the water!
- fr** Entretien du clapet anti-retour.  
couper l'arrivée d'eau!
- nl** terugslagklep onderhoud.  
water afsluiten!

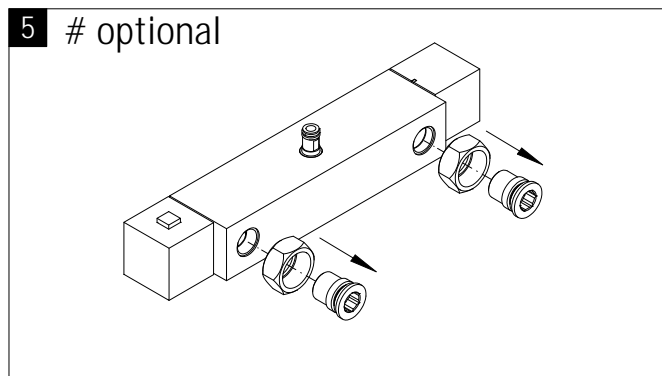
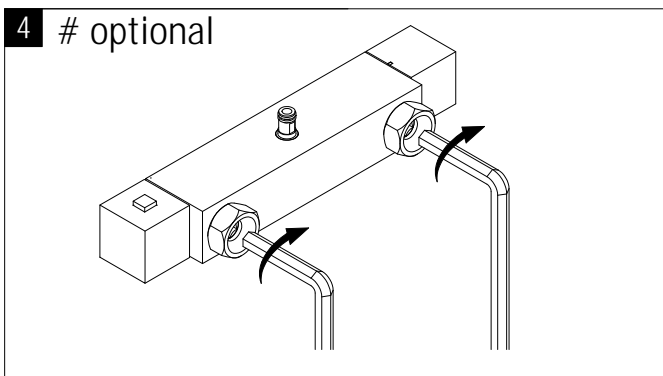
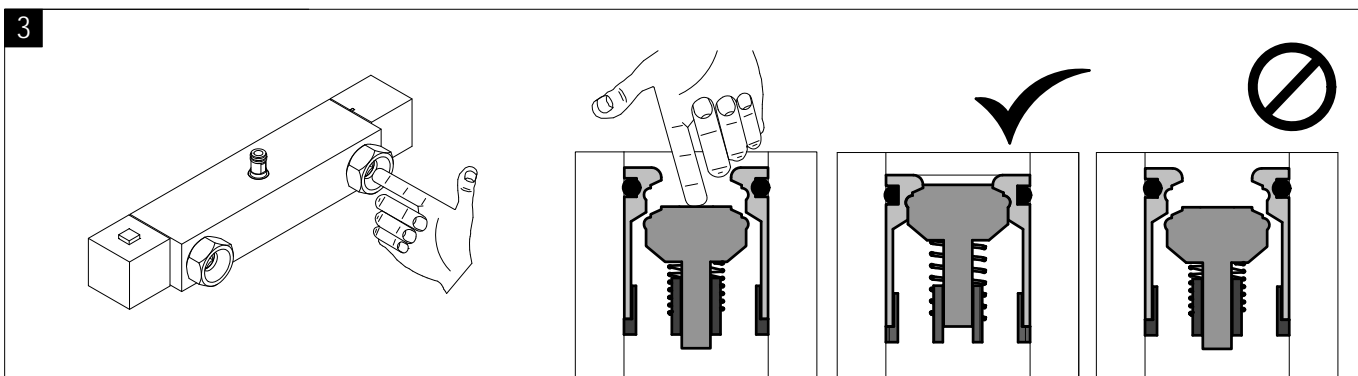
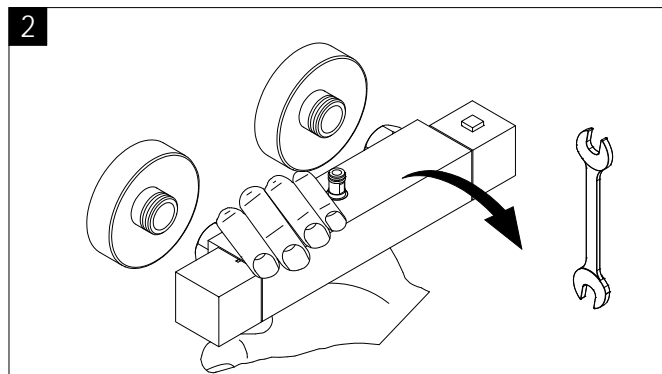
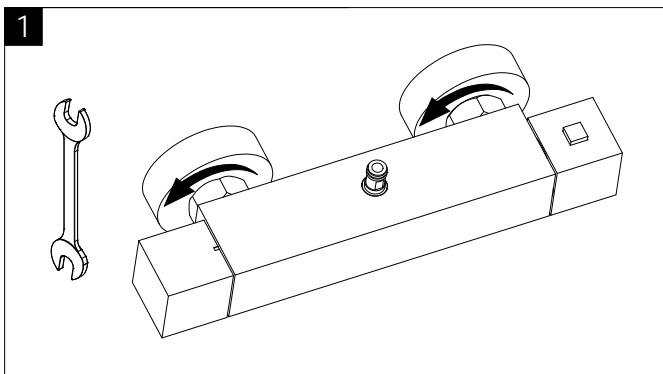

## Info

- de** Einbau in umgekehrter Reihenfolge.
- en** Installation in the reverse order.
- fr** Montage dans le sense inverse.
- nl** Inbouw in omgekeerde volgorde.

## Info

**de** Umsteller wechseln.  
Wasser abstellen!

**en** change the diverter.  
turn of the water!

**fr** changez l'inverseur.  
couper l'arrivée d'eau!

**nl** de omstelling wisselen.  
water afsluiten!

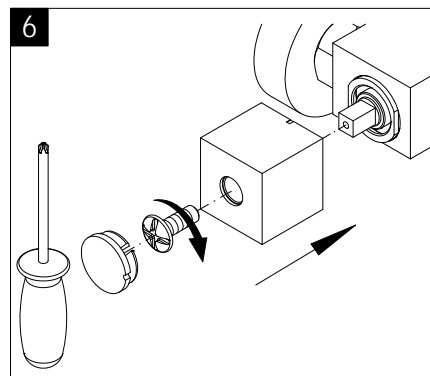
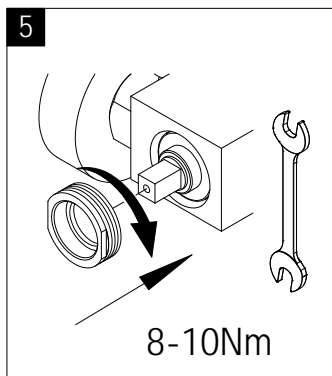
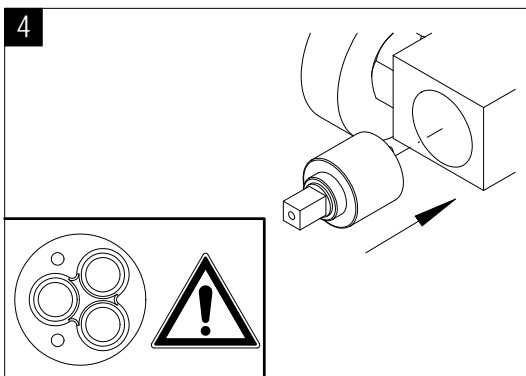
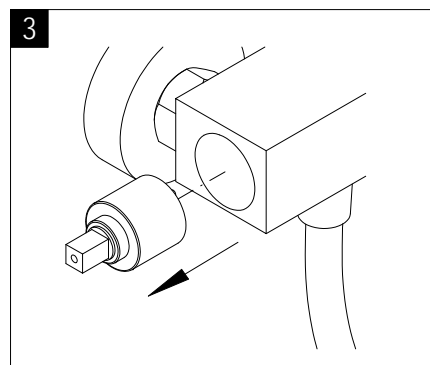
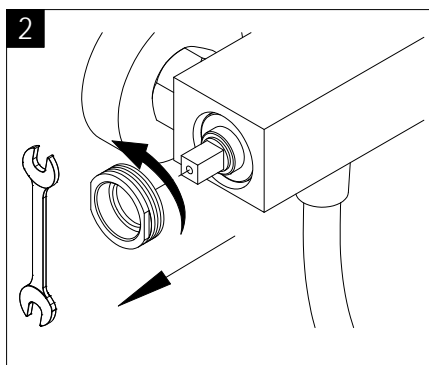
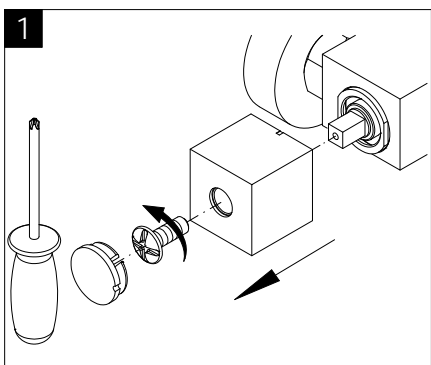
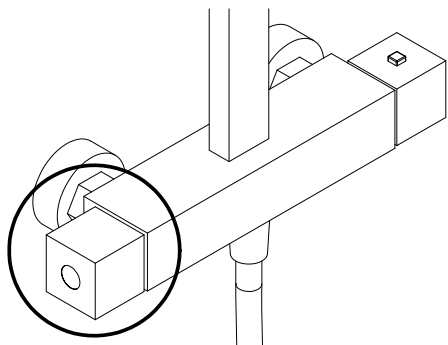

## Info

**de** Temperatureinstellung.

**en** temperature adjustment.

**fr** réglage de la température

**nl** temperatuurstelling.

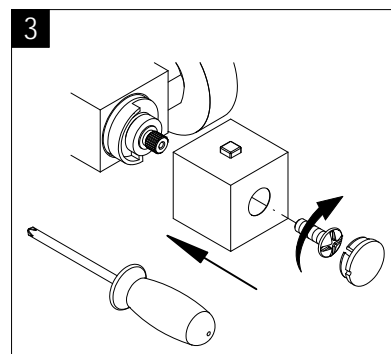
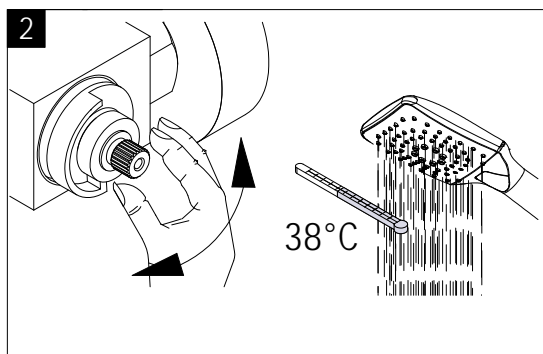
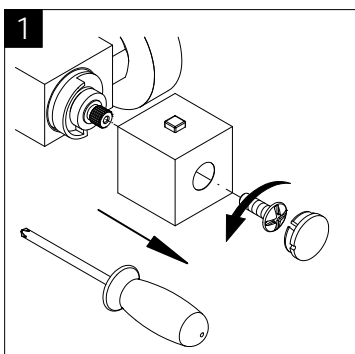
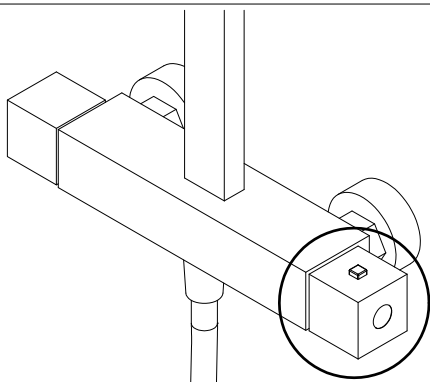

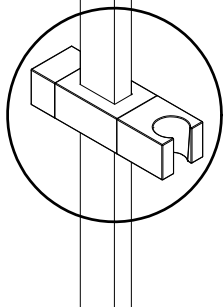

## Info

de

Gleiter wechseln.  
Wasser abstellen!

en

Glider change.  
turn of the water!

fr

changement de planer.  
couper l'arrivée d'eau!

nl

Glijder wisselgeld.  
water afsluiten!

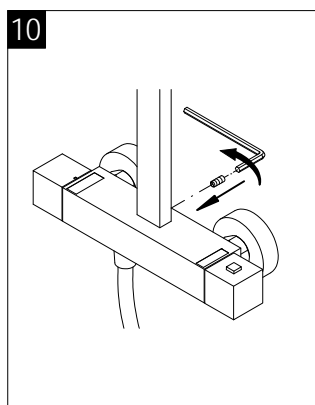
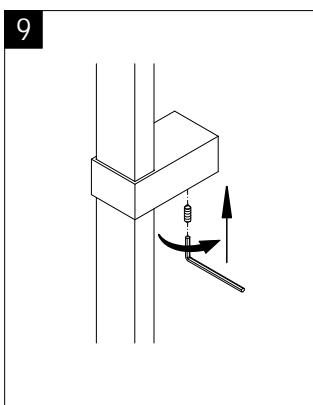
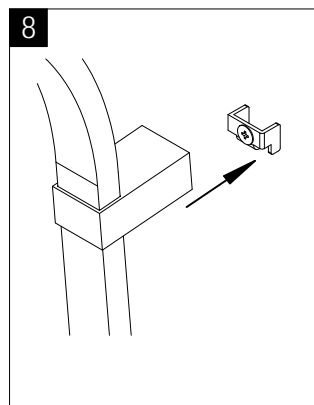
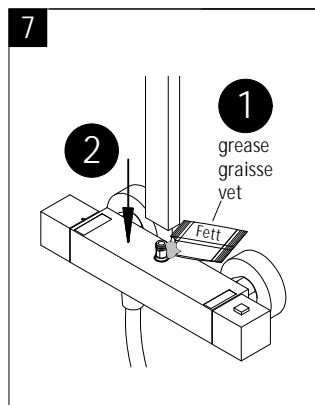
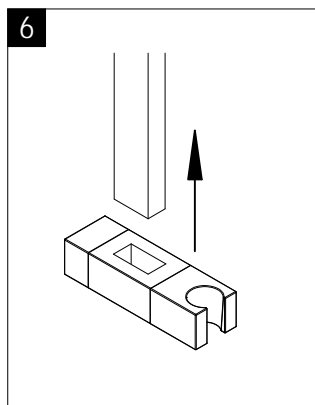
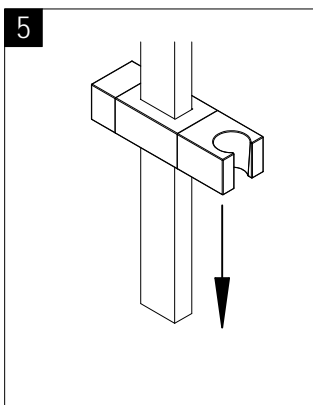
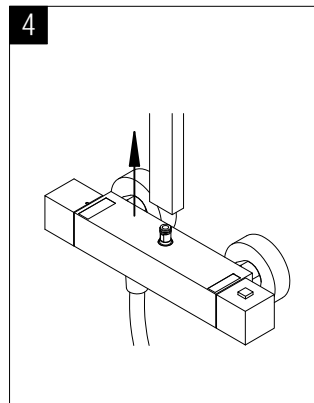
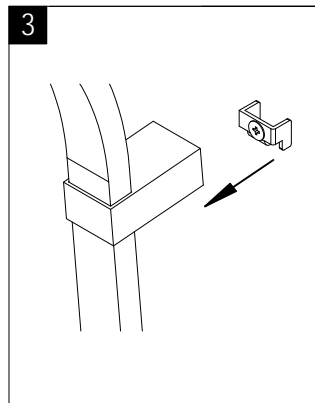
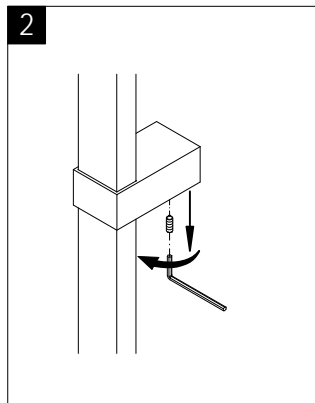
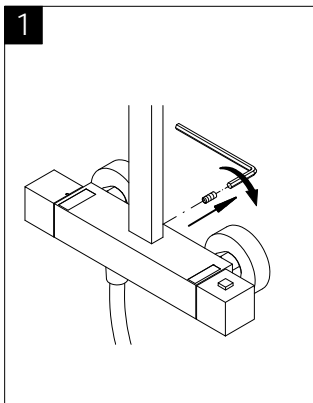

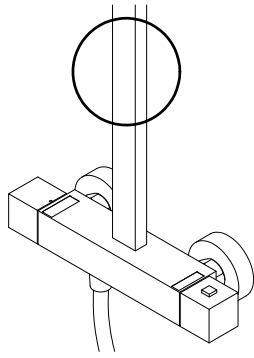

## Info

- de** Rohre austauschen  
Wasser abstellen!
- en** exchange tubes  
turn of the water!
- fr** remplacer les tuyau.  
couper l'arrivée d'eau!
- nl** leidingen vervangen  
water afsluiten!

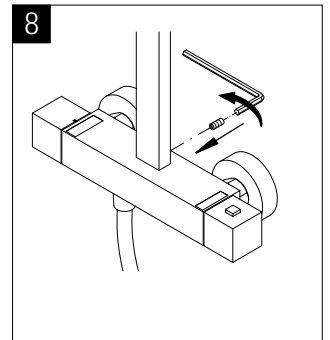
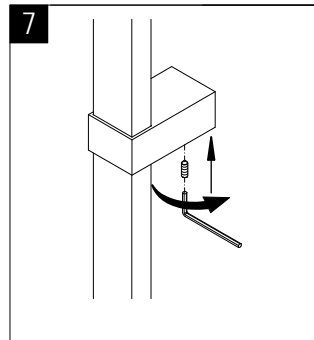
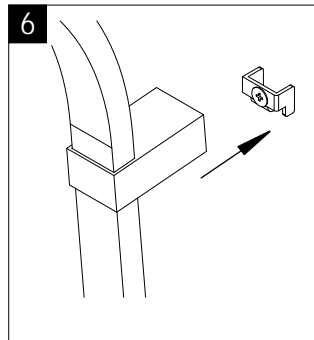
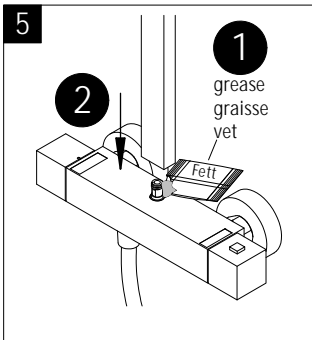
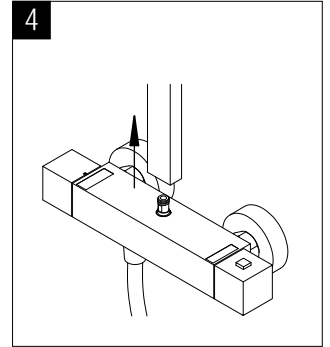
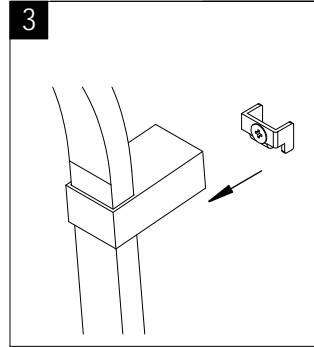
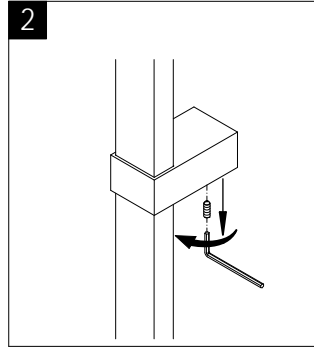
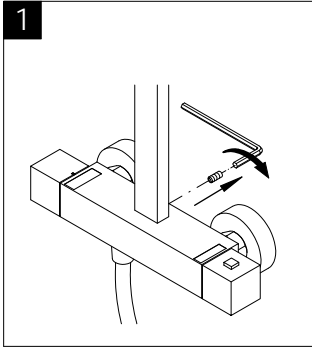

## Info

- de** Tropfende Brausen: Hand- und Kopfbrause
- en** dripping head or hand shower
- fr** pommeau haut ou dochette à main goutent
- nl** druipende dochekop of handdoche

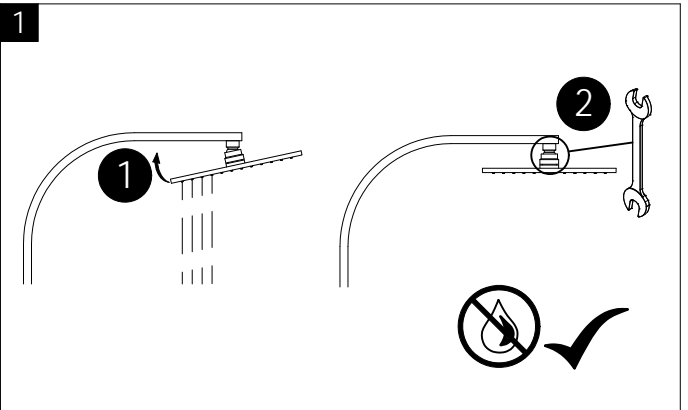

## Info

- de** Handbrausehalter verdreht sich.
- en** Hand shower support twists
- fr** support de dochette à main torsade
- nl** handdochehouder draait

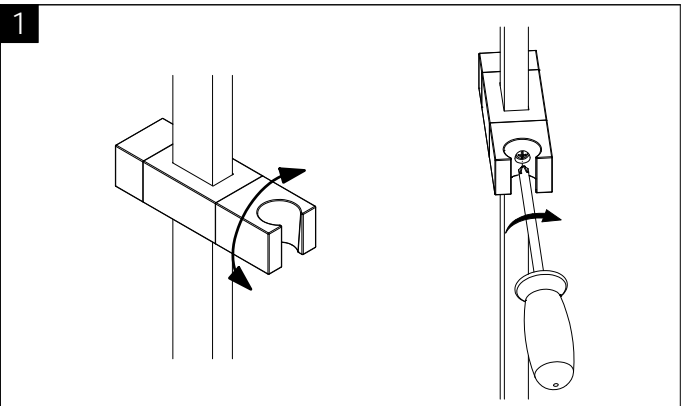

# Notizen, notes, notities

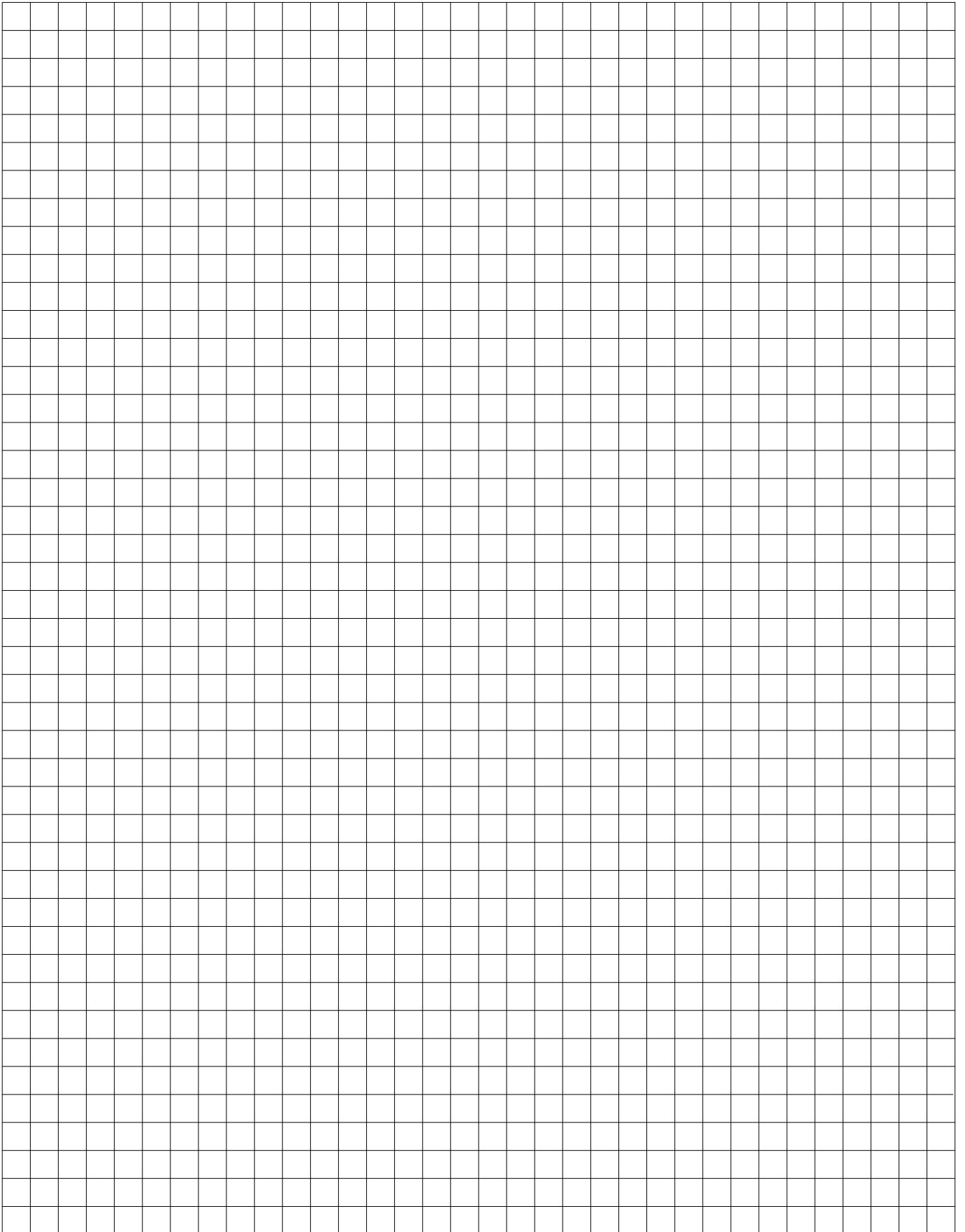

# Notizen, notes, notities

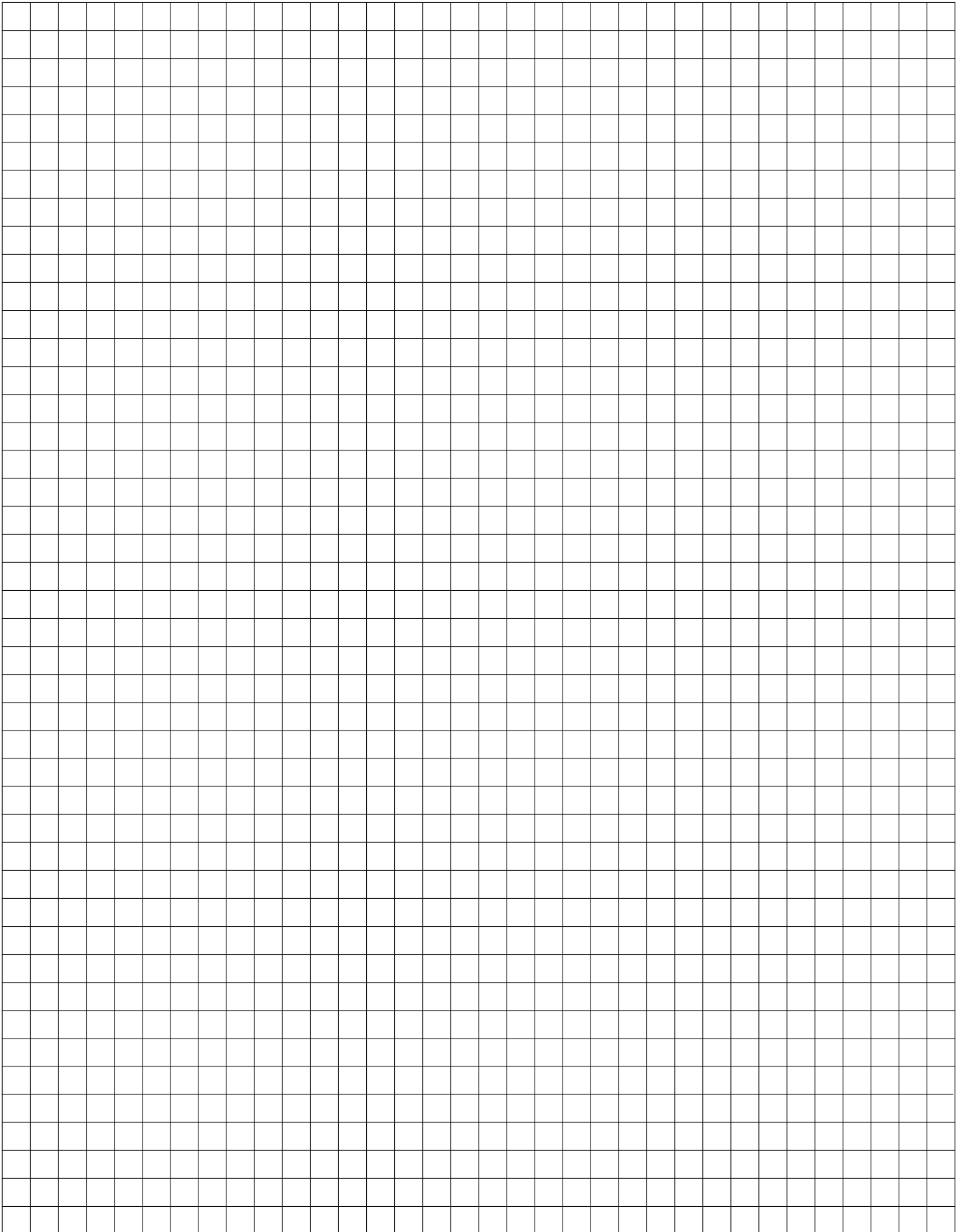

708-0

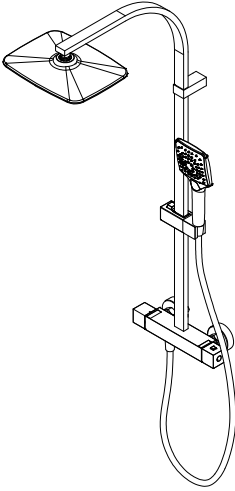

Prüfnummer / Inspection number / Numéro d'essai / Testnummer



Ersatzteilbestellung / spare parts order  
commande de pièces de rechange / Bestelling van reserveonderdelen:  
Fax 02962 / 972-4260



Technische Hilfe / technical help / l'aide technique / technologische ondersteuning  
Telefon 02962 / 972-40



E-Mail:  
[ersatzteile@duschservice.de](mailto:ersatzteile@duschservice.de)



Duschservice  
Zum Hohlen Morgen 22  
59939 Olsberg  
Deutschland / Germany / Allemagne / Duitsland